

# Soils Map

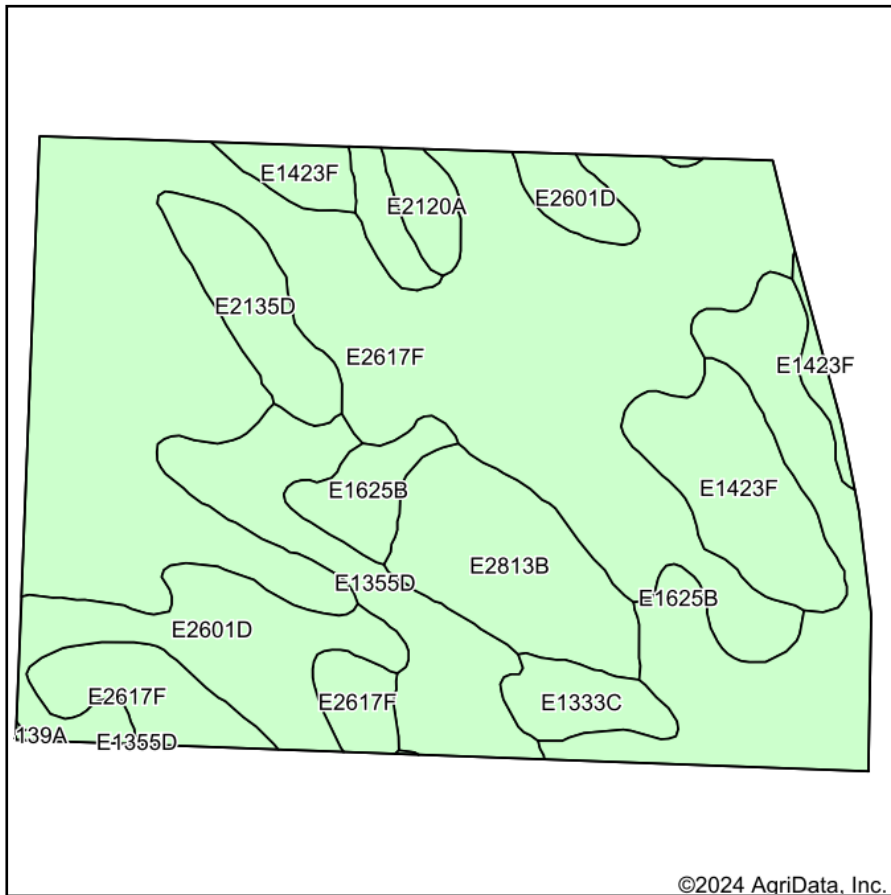

Soils data provided by USDA and NRCS.

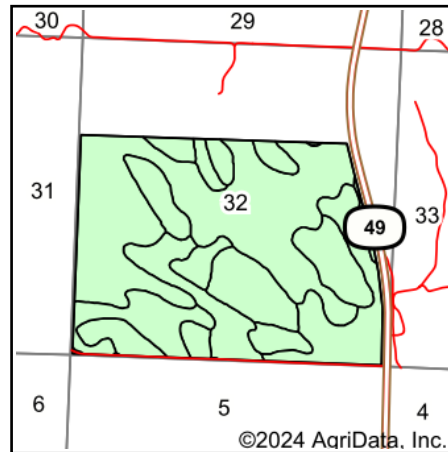

State: **North Dakota**  
 County: **Sioux**  
 Location: **32-130N-90W**  
 Township: **Menz**  
 Acres: **408**  
 Date: **2/4/2024**

Maps Provided By:



Area Symbol: ND085, Soil Area Version: 24

Code	Soil Description	Acres	Percent of field	Non-Irr Class *c	Range Production (lbs/acre/yr)	Productivity Index
E2617F	Cabba-Chama-Shambo loams, 9 to 50 percent slopes	198.01	48.5%	VIIe	1874	27
E1625B	Vebar-Parshall fine sandy loams, 3 to 6 percent slopes	53.42	13.1%	IIIe	2444	63
E2601D	Amor-Cabba loams, 9 to 15 percent slopes	34.73	8.5%	IVe	2050	40
E1423F	Flasher-Vebar-Parshall complex, 9 to 35 percent slopes	30.72	7.5%	VIIe	1936	22
E1355D	Vebar-Flasher-Tally complex, 9 to 15 percent slopes	29.86	7.3%	VIe	2103	32
E2813B	Amor-Vebar complex, 0 to 6 percent slopes	28.09	6.9%	IIe	2353	71
E2135D	Farnuf loam, 6 to 15 percent slopes	14.28	3.5%	IVe	2388	58
E1333C	Vebar-Cohagen fine sandy loams, 6 to 9 percent slopes	8.58	2.1%	IVe	2124	40
E2120A	Farnuf loam, 0 to 2 percent slopes	5.30	1.3%	IIc	2452	89
E4581B	Parshall, gravelly substratum-Manning fine sandy loams, 2 to 6 percent slopes	4.79	1.2%	IIIe	2458	61
E4139A	Korchea-Fluvaquents complex, channeled, 0 to 2 percent slopes, frequently flooded	0.22	0.1%	VIw	2852	43
<b>Weighted Average</b>				<b>5.52</b>	<b>2056.2</b>	<b>38.4</b>

\*c: Using Capabilities Class Dominant Condition Aggregation Method

Soils data provided by USDA and NRCS.