

Soils Map

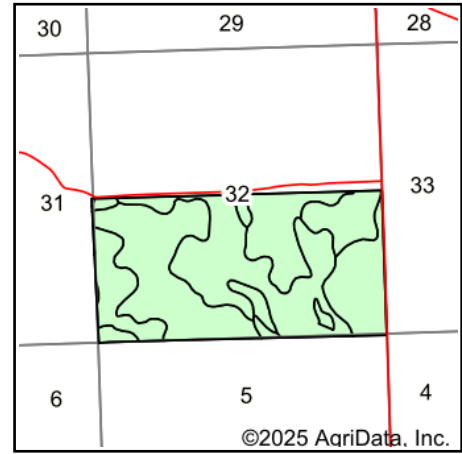
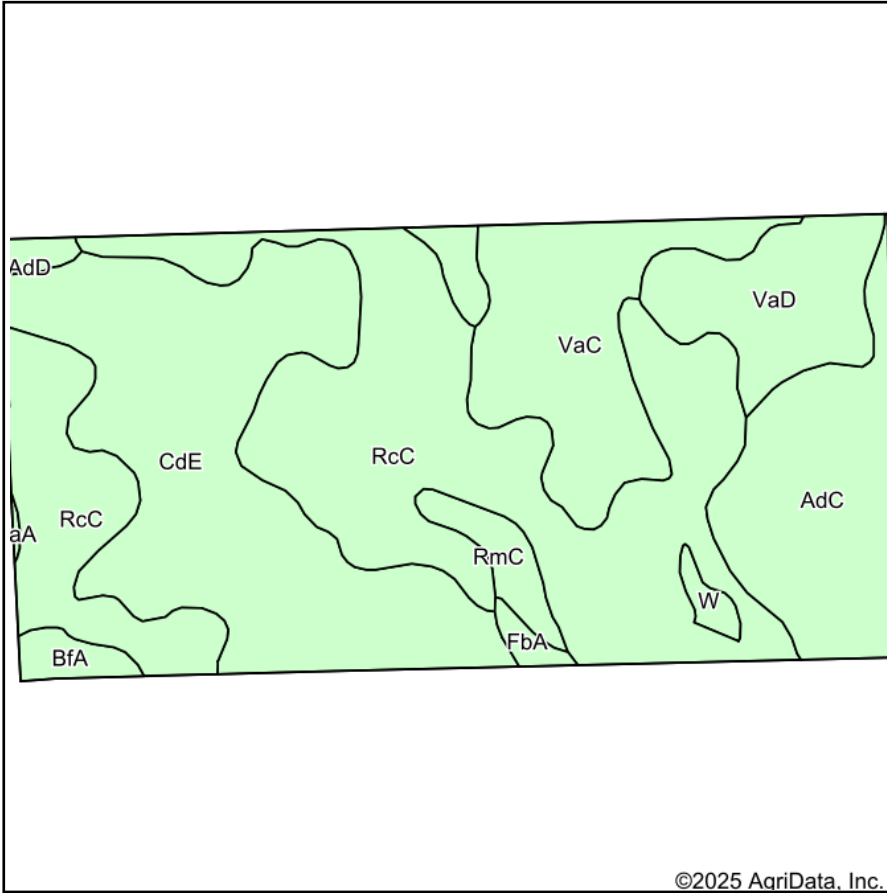

State: **South Dakota**
 County: **Perkins**
 Location: **32-22N-14E**
 Township: **Liberty**
 Acres: **320**
 Date: **4/1/2025**

©2025 AgriData, Inc.

Maps Provided By:



Soils data provided by USDA and NRCS.

© AgriData, Inc. 2023

www.AgriDataInc.com

Area Symbol: SD105, Soil Area Version: 24

Code	Soil Description	Acres	Percent of field	Non-Irr Class *c	Range Production (lbs/acre/yr)
RcC	Reeder-Lantry loams, 2 to 9 percent slopes	117.51	36.9%	IIe	2152
CdE	Cohagen-Vebar complex, 15 to 40 percent slopes	84.61	26.4%	VIIe	1745
AdC	Amor-Cabba loams, 6 to 9 percent slopes	38.18	11.9%	IIIe	2045
VaC	Vebar-Cohagen fine sandy loams, 6 to 9 percent slopes	37.01	11.6%	IVe	2124
VaD	Vebar-Flasher-Tally complex, 9 to 15 percent slopes	23.18	7.2%	VIe	2103
RmC	Rhoades-Daglum-Rhoades, severely eroded complex, 0 to 9 percent slopes	6.14	1.9%	VI s	1060
AdD	Amor-Cabba loams, 9 to 15 percent slopes	5.24	1.6%	IVe	2050
BfA	Belfield-Rhoades complex, 0 to 2 percent slopes	3.76	1.2%	III s	1929
W	Water	2.07	0.6%	VIII	0
FbA	Farnuf-Daglum loams, 0 to 3 percent slopes	1.91	0.6%	IIc	2016
FaA	Farnuf loam, 0 to 2 percent slopes	0.39	0.1%	IIc	2391
Weighted Average				4.12	1985.1

*c: Using Capabilities Class Dominant Condition Aggregation Method

Soils data provided by USDA and NRCS.